

CARTA DE MOVIMENTO NO SOLO DE AERÓDROMO (AGMC)

BELO HORIZONTE / Tancredo Neves, INTL (SBCF) MG-BRASIL

AERODROME GROUND MOVEMENT GROUND CHART (AGMC)

ARP S19 37 28 W043 58 19

LDG ROTA 2

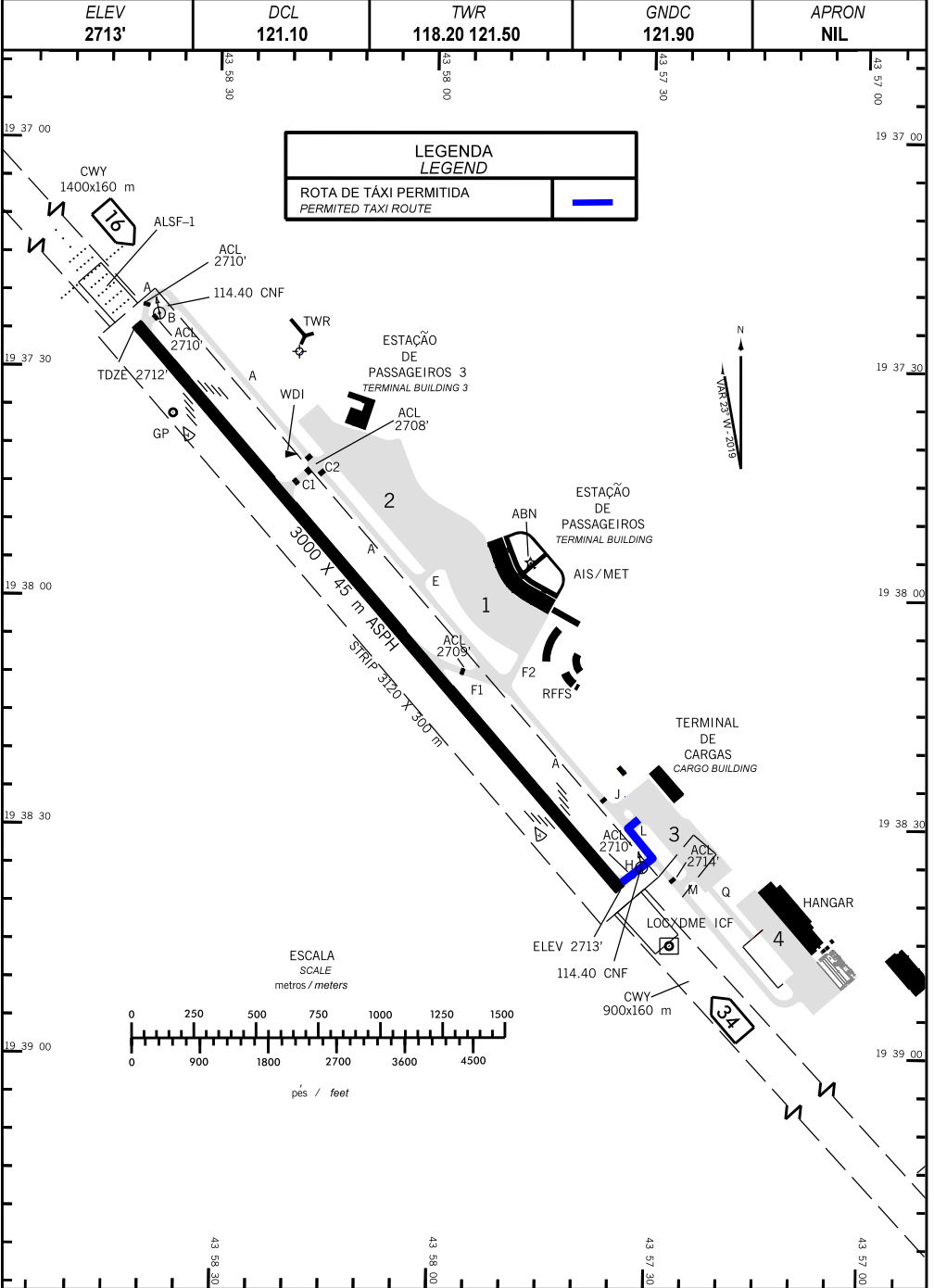

LEGENDA LEGEND	
ROTA DE TAXI PERMITIDA PERMITTED TAXI ROUTE	

ELEV 2713'	DCL 121.10	TWR 118.20 121.50	GNDC 121.90	APRON NIL
---------------	---------------	----------------------	----------------	--------------

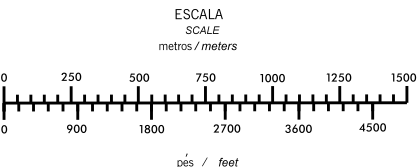

CHANGES: NEW CHART

INSTRUÇÕES:

ROTA 2: Após o pouso na RWY 16, a aeronave entra na TWY HOTEL e, em seguida, virar a esquerda na TWY ALFA e, depois virar a direita na TWY LIMA.

INSTRUCTIONS:

ROUTE 2: After landing on RWY 16, the aircraft enters TWY HOTEL and then turns left onto TWY ALFA, then turn right onto TWY LIMA.

DADOS DO AERÓDROMO

AERODROME DATA

TAXIWAYS / PISTA TWY / RWY	LARGURA WIDTH	SUPERFÍCIE SURFACE	RESISTÊNCIA STRENGTH
A (BTN TWY B and apron GOL)	23 m	ASPH	66/F/B/W/T
A (BTN TWY B and THR 16)	26 m	CONC	74/R/B/W/T
B	27 m	CONC	71/R/B/W/T
C1	26 m	ASPH	58/F/B/W/T
C2	41 m	ASPH	83/F/B/W/T
E	38 m	ASPH	83/F/B/W/T
F1	26 m	ASPH	61/F/B/W/T
F2	34 m	ASPH	56/F/B/W/T
H	26 m	ASPH	60/F/B/W/T
J	32 m	ASPH	56/F/B/W/T
L	32 m	ASPH	63/F/B/W/T
M	49, 5 m	ASPH	83/F/B/W/T
Q	23 m	ASPH	83/F/B/W/T
16/34	45 m	ASPH	83/F/B/W/T

PÁTIOS:

RESISTÊNCIA: PÁTIO 1: PCN 78/R/B/W/T
PÁTIO 2: PCN 81/R/B/W/T
PÁTIO 3: PCN 77/R/B/W/T
PÁTIO 4: PCN 60/R/A/W/U

APRONS:

BEARING STRENGTH: APRON 1: PCN 78/R/B/W/T
APRON 2: PCN 81/R/B/W/T
APRON 3: PCN 77/R/B/W/T
PÁTIO 4: PCN 60/R/A/W/U

RESTRICÇÕES: Pátio 1, 2, 3 e 4: Tipo de piso: CONC

RESTRICTIONS: Apron 1, 2, 3 and 4: Type of Surface: CONC

PONTO DE RISCO DE COLISÃO: NIL

HOT SPOT: NIL