

AIRCRAFT PARKING/
DOCKING CHART (PDC)

PORTO ALEGRE / Salgado Filho, INTL (SBPA)
RS - BRASIL

AD ELEV: 12'

ARP S29 59 41 W051 10 16

PDC 1

D-ATIS 127.85	D-CL 122.15	GNDC 121.90	TWR 118.10 121.50	APRON NIL
------------------	----------------	----------------	----------------------	--------------

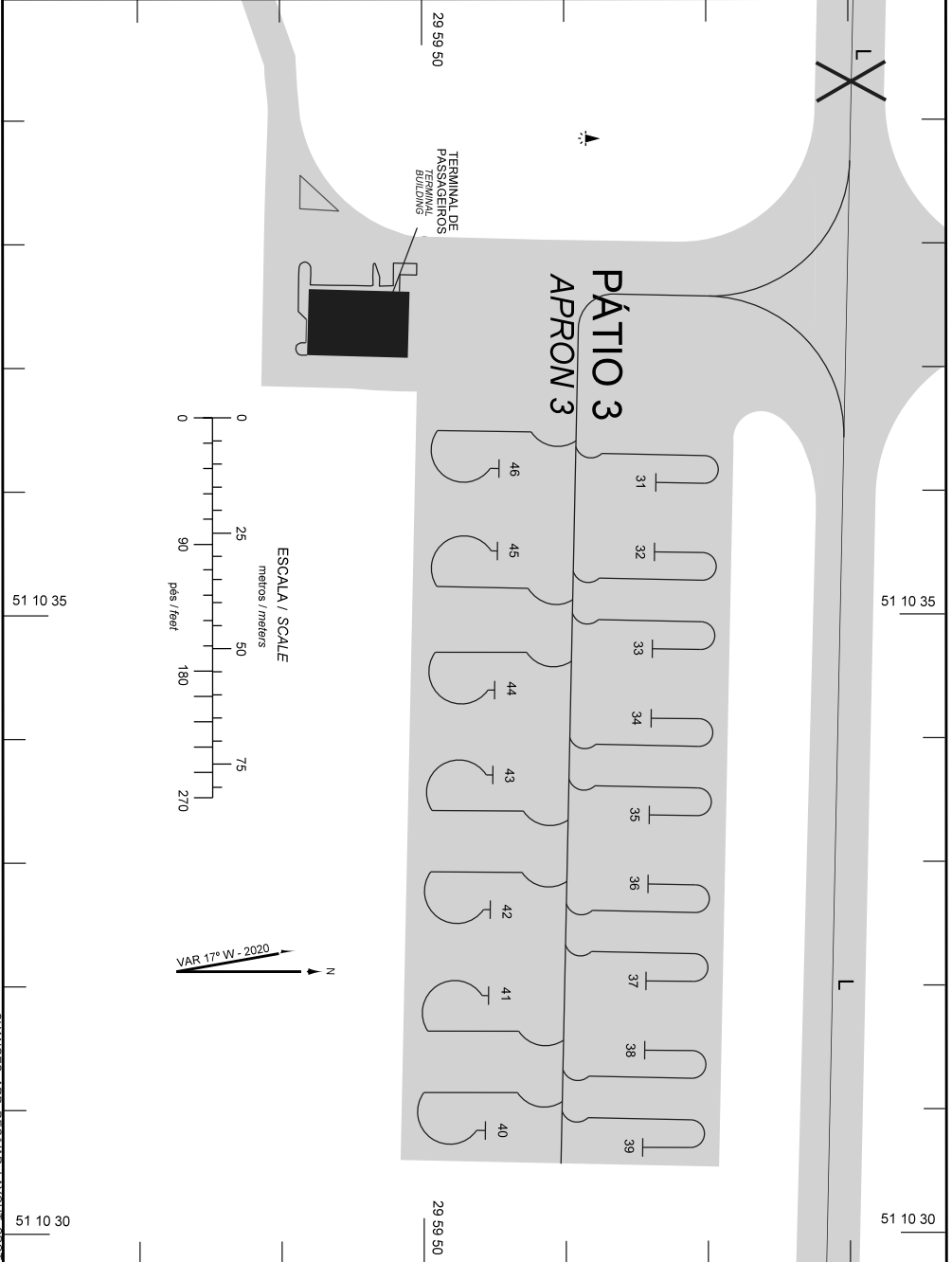

CHANGES: ARP, DEC/VAR, LAYOUT, SPOT.

**COORDENADAS DOS PONTOS DE ESTACIONAMENTO
PARKING SPOT COORDINATES**

PONTO SPOT	COORDENADAS COORDINATES	PONTO SPOT	COORDENADAS COORDINATES
PÁTIO 3 / APRON 3			
31	29 59 48.36 S 51 10 36.07 W		
32	29 59 48.37 S 51 10 35.51 W		
33	29 59 48.38 S 51 10 34.72 W		
34	29 59 48.39 S 51 10 34.16 W		
35	29 59 48.41 S 51 10 33.38 W		
36	29 59 48.42 S 51 10 32.82 W		
37	29 59 48.43 S 51 10 32.04 W		
38	29 59 48.44 S 51 10 31.48 W		
39	29 59 48.46 S 51 10 30.69 W		
40	29 59 49.57 S 51 10 30.83 W		
41	29 59 49.54 S 51 10 31.92 W		
42	29 59 49.53 S 51 10 32.64 W		
43	29 59 49.51 S 51 10 33.70 W		
44	29 59 49.49 S 51 10 34.39 W		
45	29 59 49.47 S 51 10 35.52 W		
46	29 59 49.46 S 51 10 36.18 W		

CHANGES ARP DECVAR LAYOUT SPOT